

# Contents of Carton

Before beginning installation, remove all parts from the carton to make sure everything is present. Carton contents are shown below. Part numbers for the hardware are listed in parenthesis. This grass collector kit is shipped with hardware pack 689-00600 enclosed and one hardware pack included in the mounting bracket kit.

## Bagger Assembly

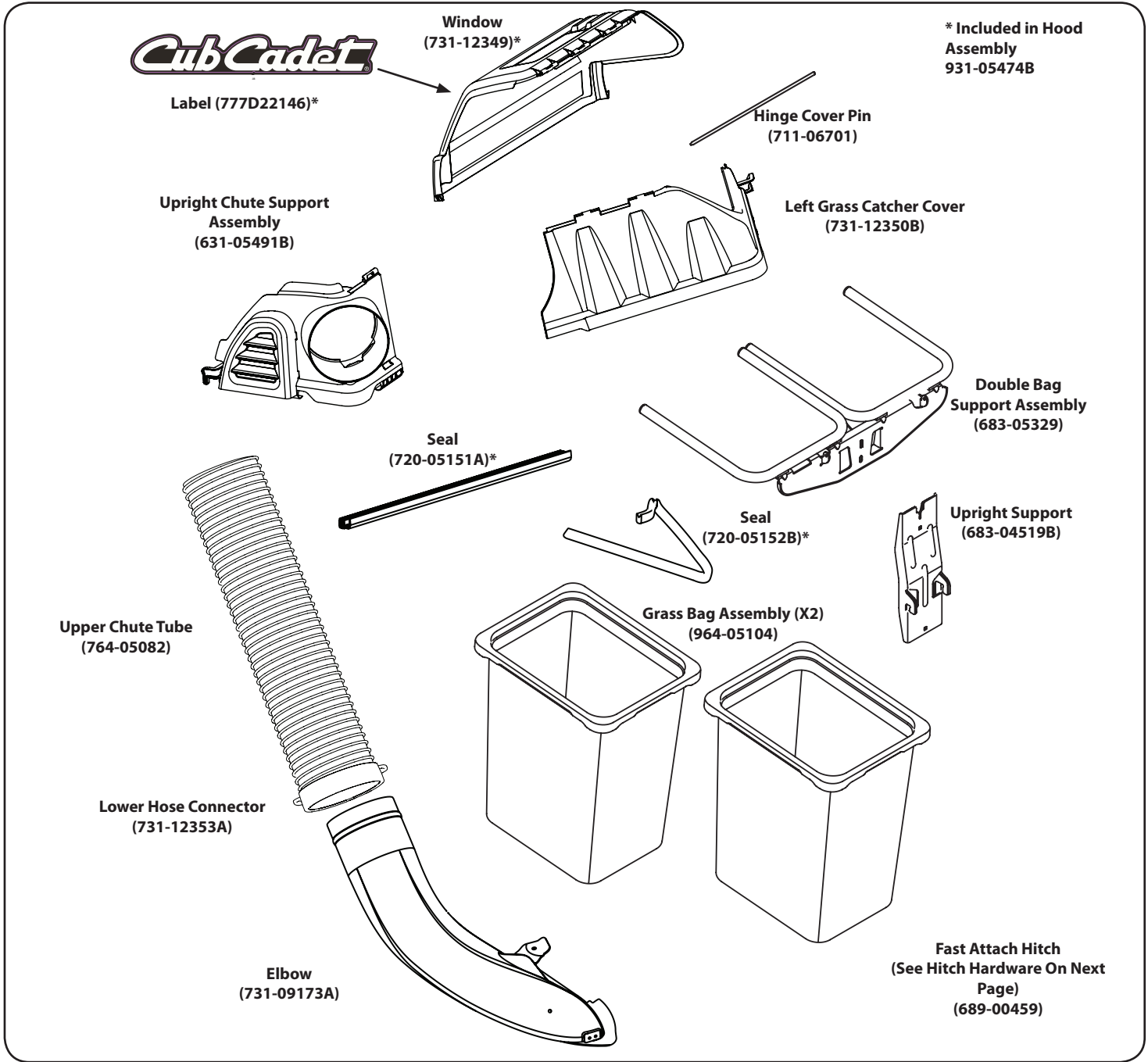

**Hardware Pack (689-00600)**  
Please check your hardware pack against the illustrations below. The quantity for each item is listed beneath.

(720-04122)  
Qty.3

(710-0276)  
Qty.2

**Hardware Pack (689-00636)**  
Please check your hardware pack against the illustrations below. The quantity for each item is listed beneath.

(738-1225)  
Qty.2

(712-04064)  
Qty.2

(747-06043)  
Qty.1

# Hitch Hardware

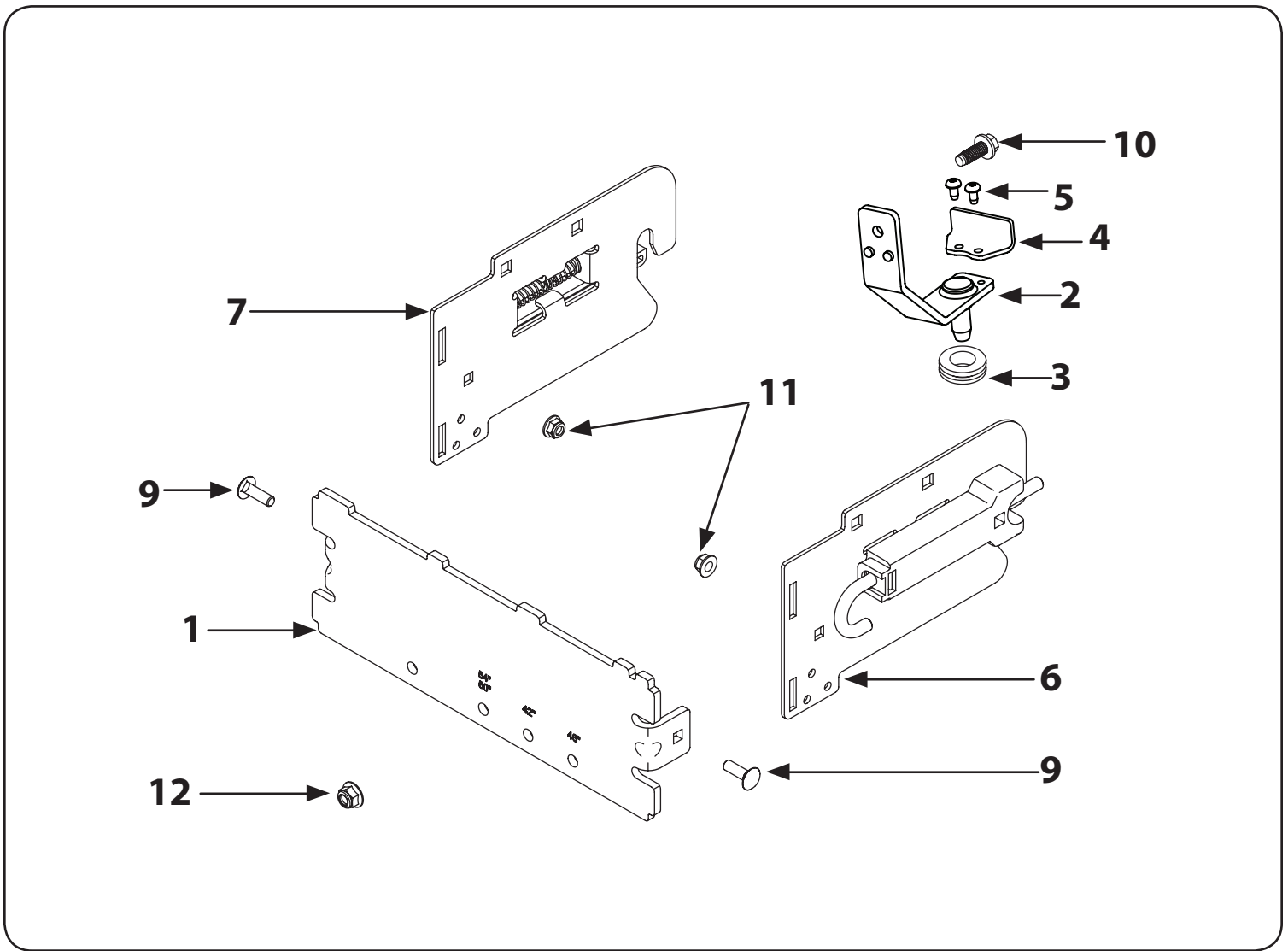

## Contents of Hitch Bracket Assembly

Ref.	Part Number	Description	Qty.
1	783-08056A	Rear Support Bracket	1
2	689-00552*	Pin Hitch Support Assembly	1
3	735-0277A	Rubber Grommet	1
4	789-00404*	Hitch Support Bracket	1
5	710-05070A*	Torx Screw: 1/4-20	2
6	689-00483B	RH Bracket Assembly	1
7	689-00484B	LH Bracket Assembly	1
NS	689-00486	Hitch Hardware Pack	1

## Hitch Hardware Pack

Ref.	Part Number	Description	Qty.
9	710-0451	Carriage Screw: 5/16-18: .750	2
10	710-04683C	Hex Screw: 3/8-16: 1.0	1
11	712-04063	Nylon Lock Nut: 5/16-18	2
12	712-04065	Flange Lock Nut: 3/8-16	1

\*These parts ship preassembled as assembly 689-00463A, Fast Attach Support Bracket Assembly.

## Required Tools

• 9/16" Socket Wrench (2)	• 1/2" Socket Wrench (1)	• M10 Socket Wrench (2)	• T-30 Torx Bit (If Needed)
---------------------------	--------------------------	-------------------------	-----------------------------

### Hitch Bracket Assembly

#### Assembling Hitch Bracket Assembly

1. Insert the ends of the rear support bracket through the narrow slots at the rear of each side support bracket. See Figure 4-1.
2. Secure folded tabs on rear support bracket to side support brackets with a carriage screw (ref. #7) and nylon lock nut (ref. #9). See Figure 4-1.

**NOTE:** The latches on the side support brackets must be positioned with the opening facing down on the outside of the bracket and the tabs on the rear support bracket must be facing up. See inset in Figure 4-1.

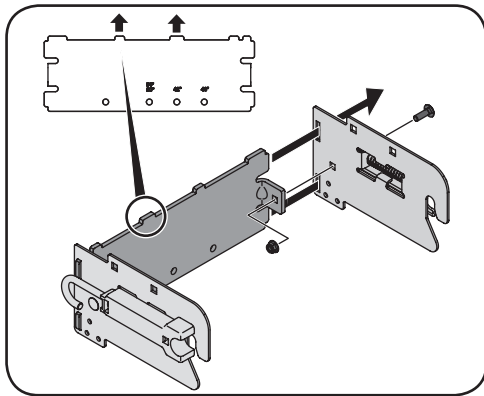

Figure 4-1

3. Flip over bracket assembly and mount the bracket support assembly (ref. #2) on the center hole of the rear support bracket using the hex screw (ref. part #8) and flange lock nut (ref. part #10). See Figure 4-2.

**NOTE:** It may be easier to leave the hex screw and flange lock nut only finger tight until mounted on the mower to ensure components properly align when installing on mower.

4. Attach the rubber grommet to the pin at the bottom of the bracket support assembly. See inset in Figure 4-2.

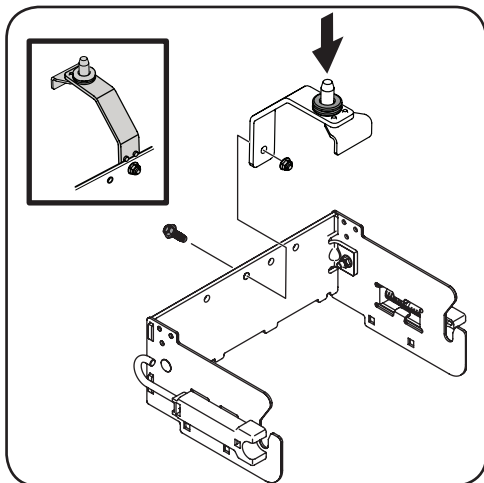

Figure 4-2

#### Installing Hitch Bracket Assembly

If your mower has a locking differential transmission you will need to remove the Hitch Support Bracket (789-00404) from the Fast Attach Support Bracket Assembly (689-00463A) before mounting the hitch to the tractor. To remove the bracket, use a T-30 torx drive to remove the two torx screws securing the assembly. See Figure 4-3.

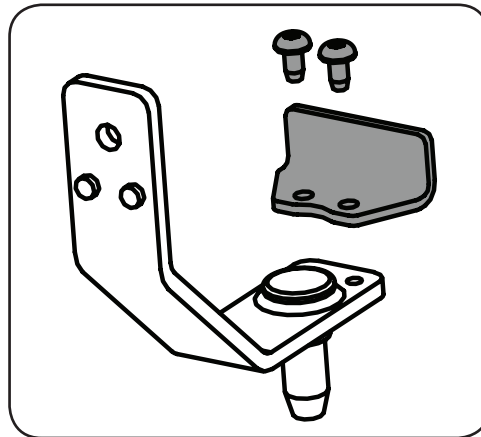

Figure 4-3

1. Flip complete hitch bracket assembly over when ready to install.
2. Pull back j-pins and lock open by twisting them inward slightly and letting them rest on the back of the rear support bracket. See Figure 4-4.

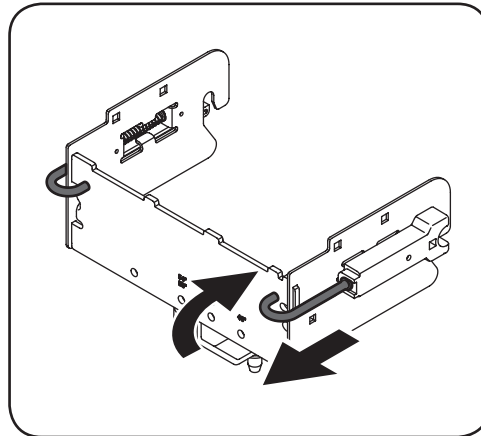

Figure 4-4

3. Slip the pin at the bottom of the bracket support assembly into the hitch adapter on the rear of the mower frame at a slight angle. See 1 in Figure 4-5.
4. Ease the hitch bracket assembly forward over the shoulder bolts on the sides of the mower frame. See 2 in Figure 4-5.

5. Release the j-pins from the rear of the bracket assembly. See 3 in Figure 4-5.

**IMPORTANT!** Make sure latches are fully engaged with the shoulder bolts on the side of the mower frame before attempting to operate, or add any other attachment.

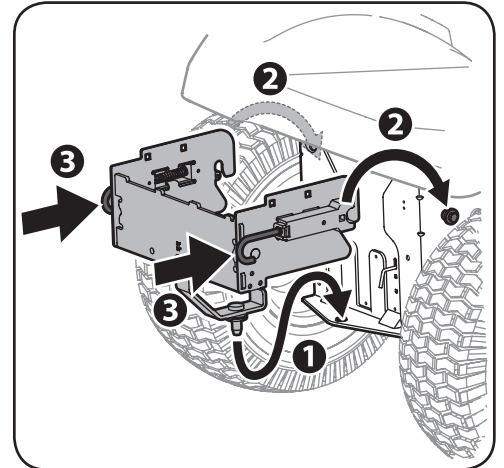

Figure 4-5

6. Fully tighten the hardware from step 3 if previously left finger tight.

#### Install the bagger hanger assembly

1. Install the upright support bracket onto the mounting assembly on the tractor by hooking it over the cross mounting bracket. See Figure 4-6.
2. Align the upright support bracket with the hole labeled "C". See inset in Figure 4-6.

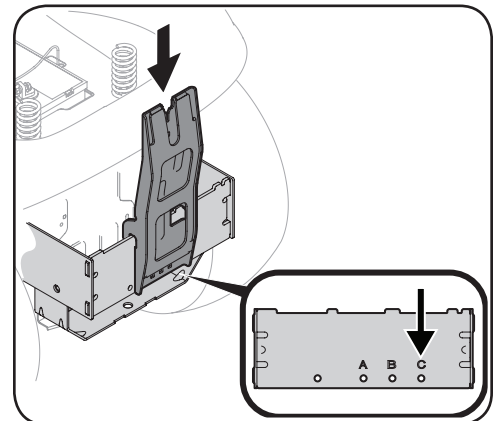

Figure 4-6

**Note:** Position "C" is the recommended mounting position, but you may use other mounting positions to accommodate other attachments.

- Secure the bag support assembly to the mounting assembly using a carriage bolt (710-0276) and wing knob (720-04122) from hardware pack 689-00600. See Figure 4-7.

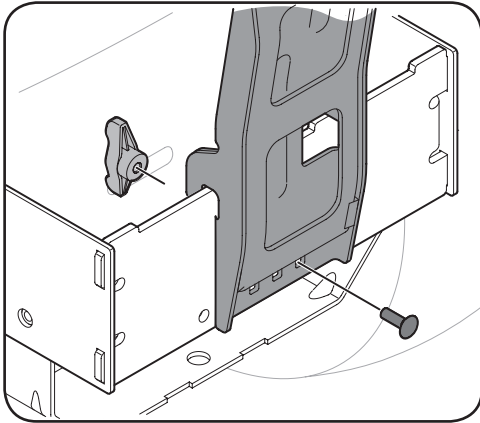

Figure 4-7

- Install the hanger assembly onto the upright support bracket using a carriage bolt (710-0276) and wing knob (720-04122) from hardware pack 689-00600. See Figure 4-8.

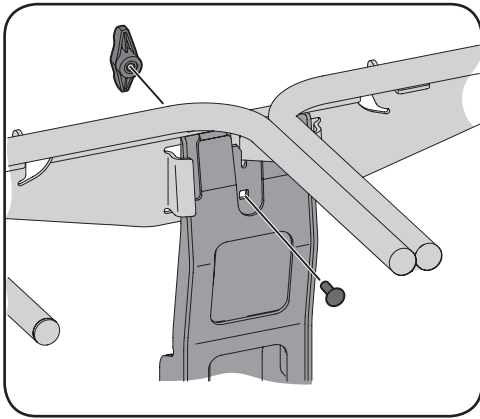

Figure 4-8

### Assembling Remaining Bagger Components

With the mounting brackets assembled and in place on the tractor, follow these steps to assemble the remaining bagger components.

- Tilt the front of the upper chute support slightly forward and snap the front side latch to the rail, as shown in (1) of Figure 4-9. Slide clip behind tab.

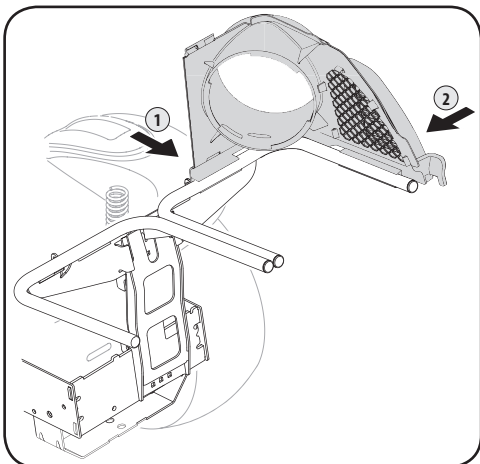

Figure 4-9

- Snap the upper chute support in place by first clipping the side portion onto the bagger support rail with the edge of the snap feature aligned with the red line, see (2) in Figure 4-9.
- Slide the left side grass catcher cover over the upper chute support and the bag support assembly. Carefully latch the two tabs in place into the front of the upper chute support, see 1 in Figure 4-10. Fit the snaps onto the left side bagger rail support. See 2 in Figure 4-10.

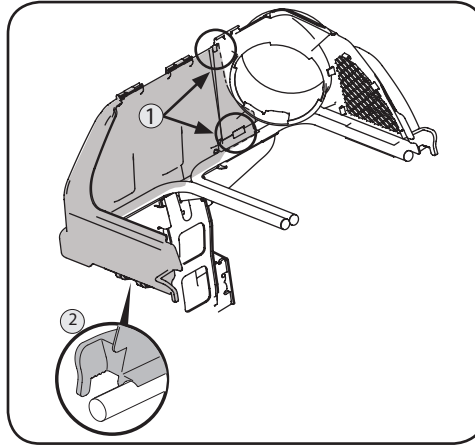

Figure 4-10

- If not already installed, apply seals (720-05151A) and (720-05152B) to the underside of the upper grass catcher cover (731-12348D) as shown below. See Figure 4-11.

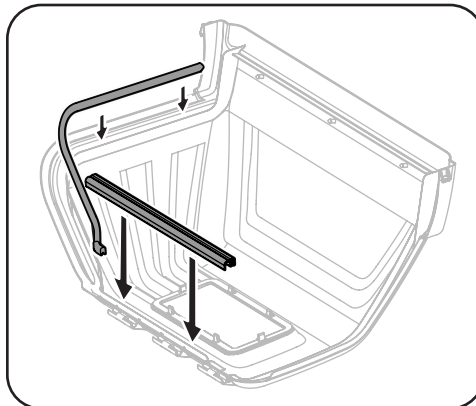

Figure 4-11

- From the front of the assembly, line up the tabs on the upper grass catcher cover with the tabs at the front of the upper chute support. Slide the hinge pin through the slots beginning at the right side upper chute support of the mounting tabs, as in Figure 4-12. Push the pin all the way in until it reaches the end-stop.

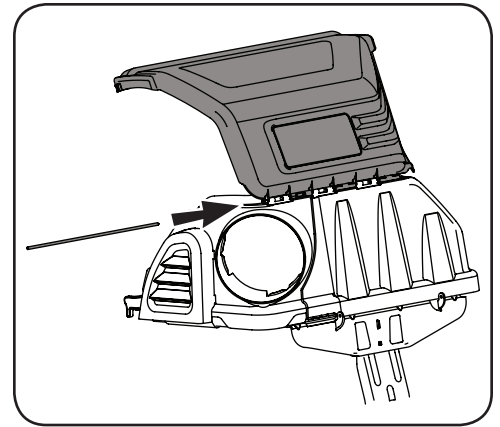

Figure 4-12

**NOTE:** The pin clips into place and is secured by a tab on each side of the bagger cover. Swing the upper grass catcher cover down to close the attachment, pushing in on the rear right-side and rear left-side tabs and lock them into place under the notches on each side. Ensure a secure, snug fit. See Figure 4-13.

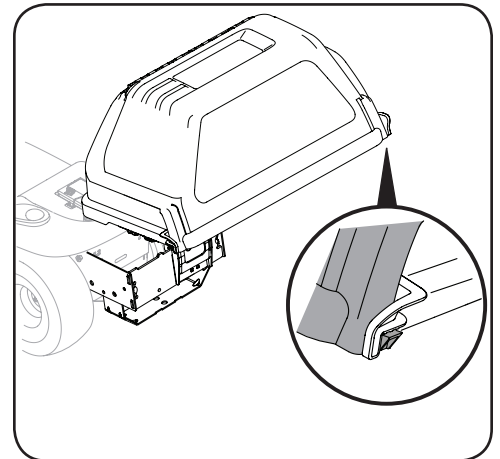

Figure 4-13

- Open the bagger cover by pushing in on the tabs and lifting the upper grass catcher cover. See Figure 4-14.

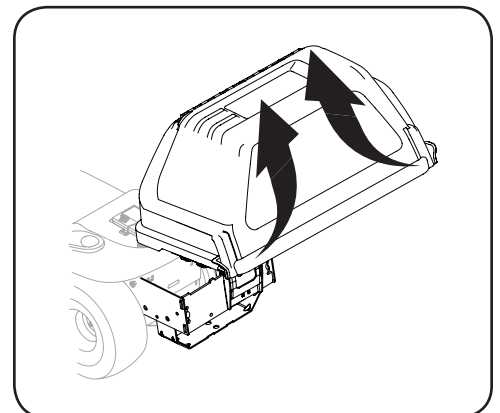

Figure 4-14

7. Install both grass bag assemblies, with the tight mesh sides facing forward, onto the bag support brackets by inserting the front edge in first, as shown in Figure 4-15, and setting the back edge down until it fits into the assembly.

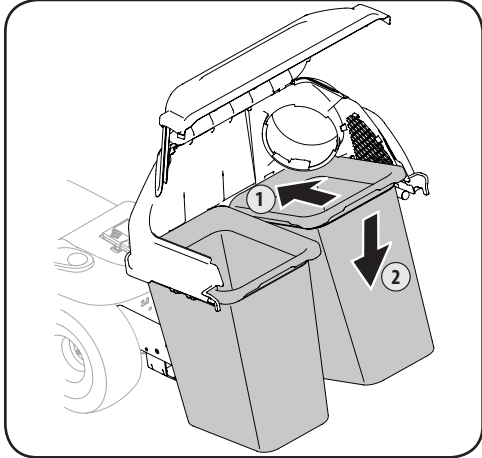

Figure 4-15

### Installing the Deck Chute

1. Install the boot rod mount (747-06043) to the boot using 2 shoulder screws (738-1225) and 2 flangelock nuts (712-04064) from hardware pack 689-00636. Ensure that the shoulder screws (738-1225) are installed on the interior of the boot. See Figure 4-16.

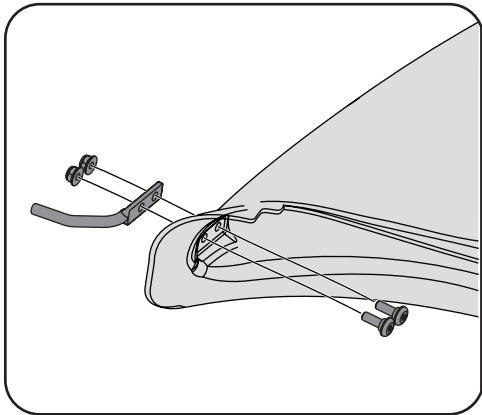

Figure 4-16

2. With the tractor's discharge chute raised up and held open (1), install the chute elbow by placing the chute elbow mounting rod into the hole provided in either your deck wheel bracket or chute mounting tab (2), as shown in Figure 4-17.

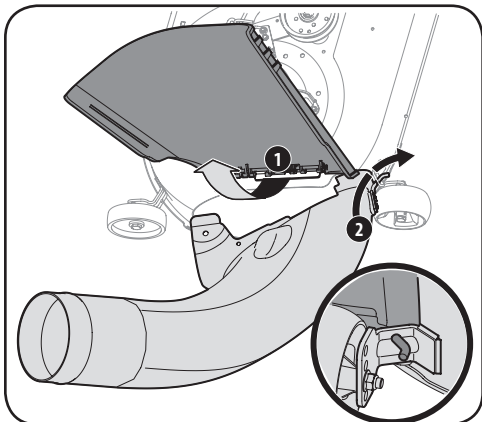

Figure 4-17

3. Secure the chute elbow to the deck using a wing knob (720-04122) from hardware pack 689-00600. See Figure 4-18.

**Note:** If present, remove the protective cap off of the mounting stud on the mowing deck as shown in the upper inset of Figure 4-18.

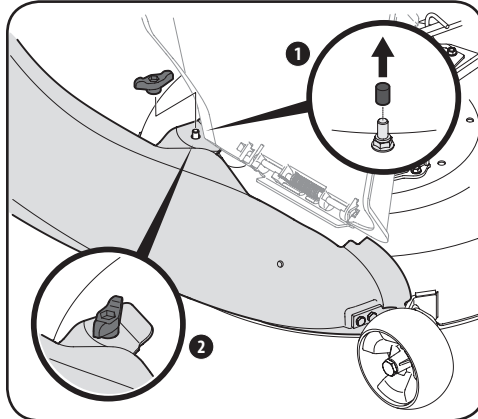

Figure 4-18

**Important!** Be certain that the bottom of the discharge chute is located inside of the lip of the deck opening, as shown in Figure 4-19.

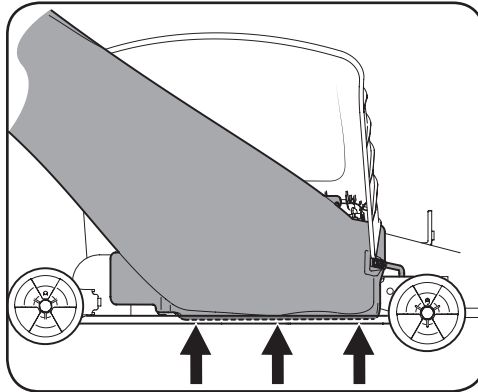

Figure 4-19

### Installing the Upper Chute Tube

1. Thread the upper end of the chute tube securely into the upper chute support. There are two tabs on the lower inside part of the upper chute support to allow for secure threading. See Figure 4-20.

**NOTE:** The chute tube and upper chute support are left-hand threaded. Thread counterclockwise until secure.

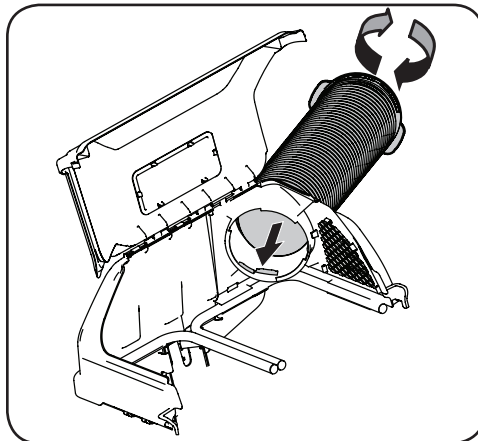

Figure 4-20

2. Lift by the handles at the bottom of the chute tube. Slide the chute tube over the chute elbow mounted on the cutting deck, as shown in Figure 4-21.

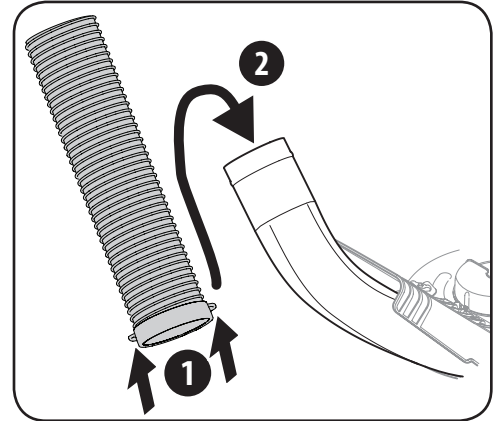

Figure 4-21

3. Make sure the connection is secure and there are no gaps between the chute tube and the chute elbow.
4. If open, close the grass catcher cover prior to mowing.